

NEW ORLEANS REGIONAL TRANSIT AUTHORITY

INDEX OF SHEETS

SHT # DESCRIPTION

- 1 TITLE SHEET
- 2 PHASE 1 - OVERALL SITE PLAN
- 3 ELK PLACE SITE PLAN
- 4 TULANE AVENUE DEMOLITION & PAVING PLAN
- 5 TULANE AVENUE GRADING & SITE PLAN
- 6 TULANE AVENUE (ADD. ALTERNATE) DEMOLITION & PAVING PLAN
- 7 LOYOLA AVENUE & GRAVIER STREET SITE PLAN

INTERIM DOWNTOWN TRANSIT HUB - PHASE 1

JUNE 2022

90% DESIGN DRAWINGS

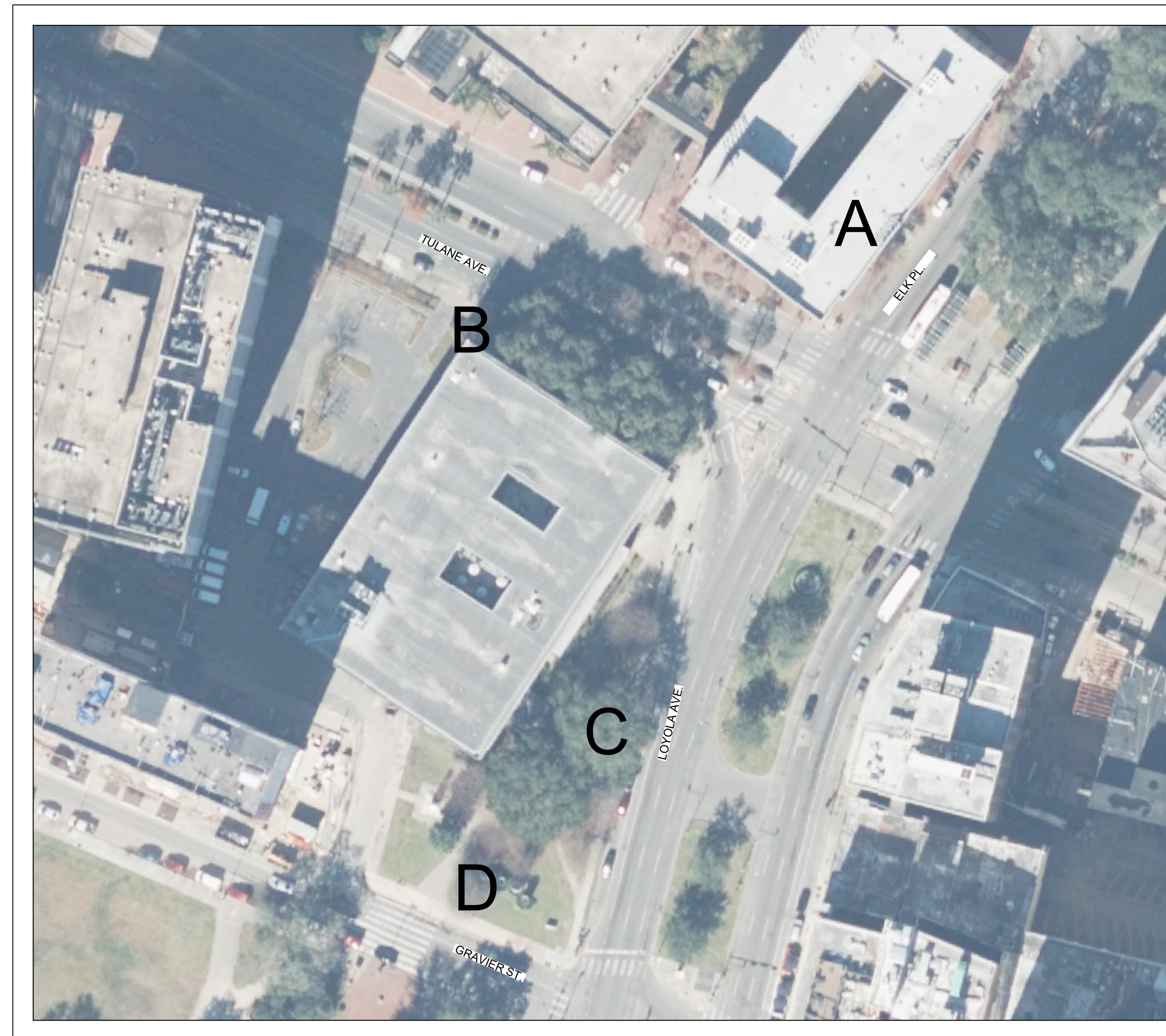

VICINITY MAP
SCALE: 1" = 60'

STAKEHOLDERS INFO.

NEW ORLEANS REGIONAL TRANSIT AUTHORITY (RTA)
2817 CANAL STREET
NEW ORLEANS, LA 70119
(504) 248-3900

CITY OF NEW ORLEANS DEPARTMENT OF PUBLIC WORKS (DPW)
1300 PERDIDO STREET SUITE 6W03
NEW ORLEANS, LA 70112
(504) 658-8040

NEW ORLEANS PUBLIC LIBRARY (NOPL)
5120 SAINT CHARLES AVENUE
NEW ORLEANS, LA 70115
(504) 596-2625

TULANE UNIVERSITY
6823 SAINT CHARLES AVENUE
NEW ORLEANS, LA 70118
(504) 865-5000

RTA INTERIM DOWNTOWN TRANSIT HUB

- SITE A: ELK PLACE FOR NEW ORLEANS EAST BUSES
- SITE B: TULANE AVENUE (RIVERBOUND) FOR WESTBANK BUS ROUTES
- SITE C: LOYOLA AVENUE FOR GENTLY/MIDCITY AND THROUGH ROUTES
- SITE D: GRAVIER STREET

APPROVED BY:

GOTECH, INC. DATE

NEW ORLEANS REGIONAL TRANSIT AUTHORITY DATE

PRELIMINARY 90% DESIGN

NOT TO BE USED FOR CONSTRUCTION, BIDDING, RECORDATION, CONVEYANCE, SALES OR AS THE BASIS FOR THE ISSUANCE OF A PERMIT.

GOTECH, INC.
8383 Bluebonnet Blvd.
Baton Rouge, LA 70810

ENGINEER: JOHN F. SCHENKNER
LICENSE # 33894
DATE: JUNE 10TH 2022

Project No.: 890
Sheet No.: 1

NEW ORLEANS RTA
INTERIM DOWNTOWN TRANSIT HUB - PHASE 1
TITLE SHEET

REVISIONS

DATE

NO.

G O T E C H , I N C .
CONSULTING ENGINEERS | 8383 BLUEBONNET BLVD. | BATON ROUGE, LA. 70810
PHONE: (225)766-5358 | FAX: (225)766-5879

DESIGNED: JFS
DRAWN: HJS
CHECKED: JAW
APPROVED: JFS
SCALE: N/A
DATE: JUNE 10, 2022

NO.	DATE	REVISIONS

DESIGNED:	JFS
DRAWN:	HJS
CHECKED:	JAW
APPROVED:	JFS
SCALE:	1" = 40'
DATE:	JUNE 10, 2022

RTA INTERIM DOWNTOWN TRANSIT HUB - PHASE I

1. ELK PLACE SITE PLAN CONSISTS OF THE FOLLOWING:
 - A. PAVEMENT STRIPING ON THE NORTHERNMOST WESTBOUND TRAVEL LANE OF ELK PLACE TO INDICATE BUS ONLY TRAFFIC.
 - B. RELOCATING TRASH CAN AND NEW ORLEANS TOURISM WAYFINDING SIGN.

2. TULANE AVENUE SITE PLAN CONSISTS OF THE FOLLOWING:
 - A. PAVEMENT STRIPING ALONG OUTERMOST LANE OF EASTBOUND TULANE AVENUE TO INDICATE BUS ONLY TRAFFIC.
 - B. MODIFICATIONS TO NEW ORLEANS LIBRARY PARKING LOT CIRCULATION PLAN TO CREATE EXIT ONLY ON THE WESTERN DRIVE AND ENTRANCE ONLY ON THE EASTERN DRIVE.
 - C. SIDEWALK MODIFICATIONS FROM THE CORNER OF LOYOLA AVENUE THROUGH PROPOSED BUS SHELTER AREA, AS INDICATED. THIS WILL CREATE AN ADA-COMPLIANT SIDEWALK AREA.
 - D. ADD ALTERNATE FOR EXTENDED SIDEWALK REHABILITATION ALONG TULANE AVENUE THROUGH LIBRARY DRIVEWAYS, AS INDICATED.
 - E. INSTALLATION OF 27' BUS SHELTER.

3. LOYOLA AVENUE SITE PLAN CONSISTS OF THE FOLLOWING:
 - A. PAVEMENT STRIPING ALONG LOYOLA AVENUE TO INDICATE BUS ONLY TRAFFIC
 - B. EXTENSION OF EXISTING SIDEWALK FROM EXISTING SIDEWALK TO BACK OF CURB.
 - C. INSTALLATION OF 2 - 27' BUS SHELTERS ALONG LOYOLA AVENUE.
 - D. SIDEWALK PAVING TO FACILITATE NEW BUS SHELTERS.
 - E. INSTALLATION OF NEW 27' BUS SHELTER ALONG TULANE AVENUE.

4. GRAVIER STREET SITE PLAN CONSISTS OF THE FOLLOWING:
 - A. PAVEMENT STRIPING ALONG GRAVIER STREET TO INDICATE BUS ONLY TRAFFIC.
 - B. RELOCATION OF EXISTING BOOK DROP-OFF.

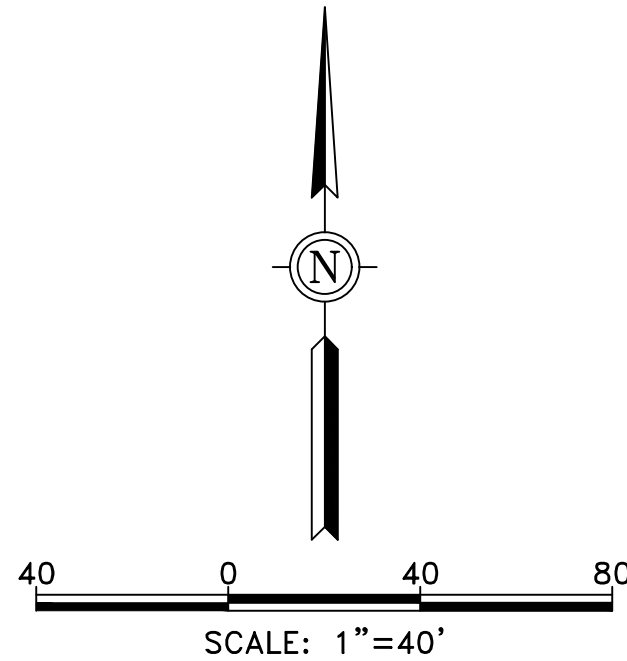

PRELIMINARY 90% DESIGN
 NOT TO BE USED FOR CONSTRUCTION, BIDDING, RECORDATION, CONVEYANCE, SALES OR AS THE BASIS FOR THE ISSUANCE OF A PERMIT.
 GOTECH, INC.
 8383 Bluebonnet Blvd.
 Baton Rouge, LA 70810
 ENGINEER: JOHN F. SCHENKNER
 LICENSE # 33894
 DATE: JUNE 10TH 2022

NO.	DATE	REVISIONS

DESIGNED:	JFS
DRAWN:	HJS
CHECKED:	JAW
APPROVED:	JFS
SCALE:	1" = 10'
DATE:	JUNE 10, 2022

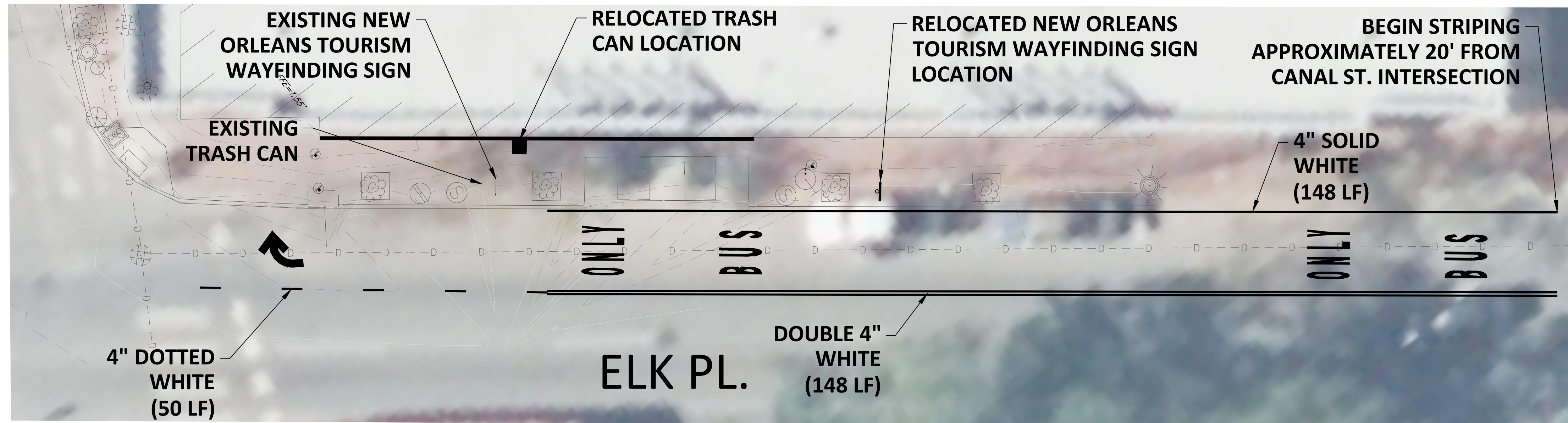

- LEGEND**
- ⊙ DRAIN MH
 - ⊕ FIRE HYDRANT
 - ☀ GENERAL LIGHT
 - ⊗ GAS METER
 - ⊕ GAS VALVE
 - ⊙ MECHANICAL POINT
 - ⊠ POWER TRANSFORMER
 - ⊠ POWER VAULT
 - ⊕ POWERPOLE
 - ⊙ SEWER MANHOLE
 - ⊗ SEWER CLEANOUT
 - ⊕ SIGN
 - ⊕ WATER VALVE
 - 🌳 TREE
- S--- SEWER LINE
 ---E---E--- ELECTRIC LINE (BELOW GRD)
 ---P--- ELECTRIC LINE (ABOVE GRD)
 ---D---D--- DRAINAGE LINE (8" DIA. AND BELOW)
 === DRAINAGE LINE (10" DIA. AND ABOVE)
 ---G--- GAS LINE
 ---W--- WATER LINE
 -X-X- FENCE LINE

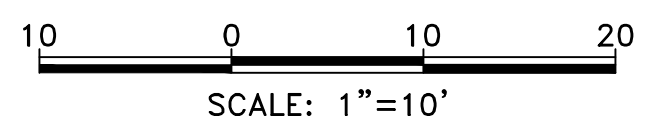

1 ELK PLACE SITE PLAN
Scale = 1"=10'

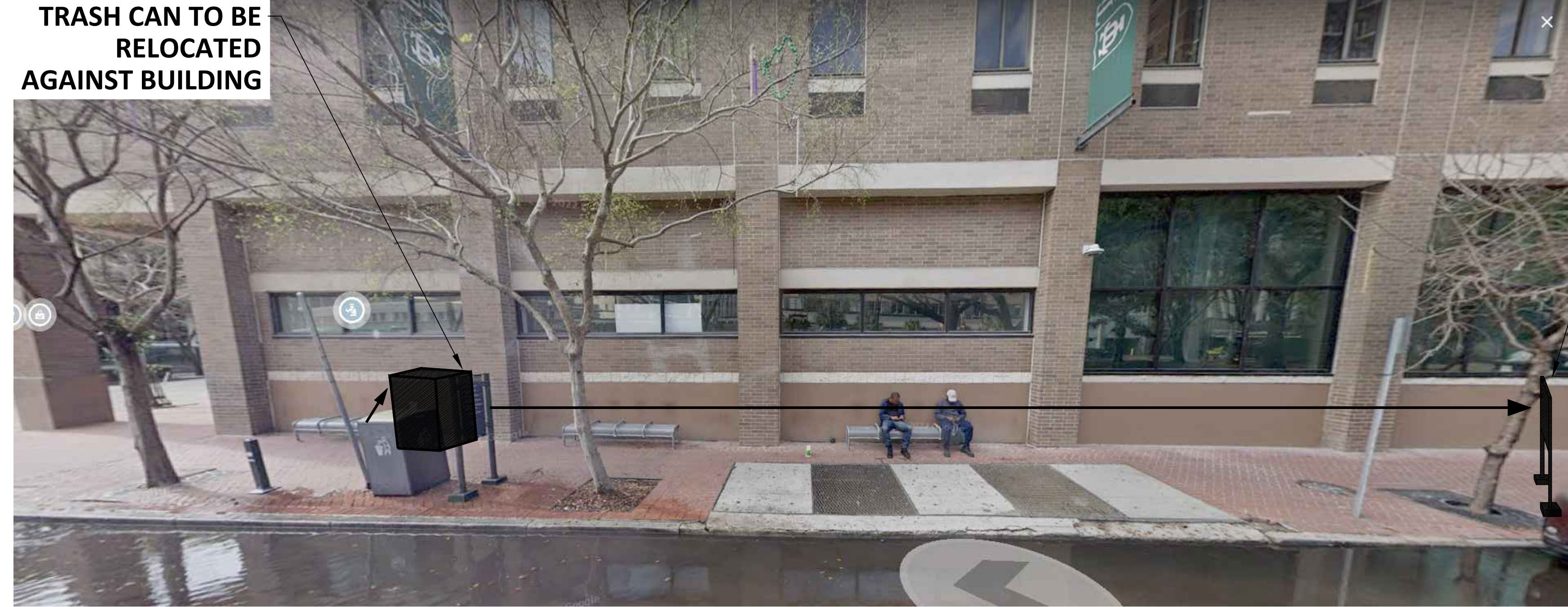

2 ELK PLACE STREET VIEW
Scale = N.T.S.



3 NEW ORLEANS TOURISM WAYFINDING SIGN
Scale = N.T.S.

NOTE: SIGN TO BE RELOCATED AS INDICATED IN PLAN. SEE NOTE 3.

ELK PLACE NOTES

1. NEW ORLEANS RTA DOWNTOWN TRANSIT HUB - ELK PLACE SITE PLAN CONSISTS OF THE FOLLOWING:
 - A. PAVEMENT STRIPING ON THE NORTHERNMOST WESTBOUND TRAVEL LANE OF ELK PLACE TO INDICATE BUS ONLY TRAFFIC.
 - B. RELOCATING TRASH CAN AND NEW ORLEANS TOURISM WAYFINDING SIGN.
2. RELOCATED TRASH CAN LOCATION SHOWN IS CONCEPTUAL. CONTRACTOR TO RELOCATE TRASH CAN TO THE WEST, AGAINST THE EXISTING BUILDING BASED ON MOST OPTIMAL SITE CONDITIONS. ACTUAL RELOCATION LOCATION TO BE APPROVED BY RTA PRIOR TO INSTALLATION.
3. RELOCATED NEW ORLEANS TOURISM WAYFINDING SIGN LOCATION SHOWN IS CONCEPTUAL. CONTRACTOR TO RELOCATE WAYFINDING SIGN IN GENERAL LOCATION AS INDICATED BASED ON MOST OPTIMAL SITE CONDITIONS. ACTUAL LOCATION TO BE APPROVED BY NEW ORLEANS TOURISM PRIOR TO INSTALLATION.
4. AFTER TRASH CAN AND WAYFINDING SIGN ARE MOVED FROM THEIR EXISTING LOCATIONS, CONTRACTOR TO REPAIR UNDERLYING AREA TO MATCH SURROUNDING EXISTING BRICK PAVER SIDEWALKS, AS NECESSARY.

PAVEMENT STRIPING NOTES

1. ALL PAVEMENT STRIPING WORK TO BE COORDINATED WITH THE CITY OF NEW ORLEANS DEPARTMENT OF PUBLIC WORKS, 1300 PERDIDO STREET, ROOM 6W03, NEW ORLEANS, LA 70112, (504) 658-8000.
2. PAVEMENT STRIPING TO BE INSTALLED PER REQUIREMENTS OF CITY OF NEW ORLEANS DEPARTMENT OF PUBLIC WORKS STANDARD DRAWING PM1.
3. ALL PAVEMENT MARKINGS SHALL BE RETROREFLECTIVE.
4. DOTTED LINE STRIPING SHALL CONSIST OF 3-FOOT LINE SEGMENTS AND 9-FOOT GAPS.
5. BUS ONLY SYMBOLS TO BE ELONGATED LETTERS 8-FEET LONG AND SHALL BE IN ACCORDANCE WITH THE DESIGN DETAILS OF THE PAVEMENT MARKINGS CHAPTER OF THE FHWA "STANDARD HIGHWAY SIGNS AND MARKINGS" (SECTION 1A.11). CURRENT EDITION.

PRELIMINARY 90% DESIGN

NOT TO BE USED FOR CONSTRUCTION, BIDDING, RECORDATION, CONVEYANCE, SALES OR AS THE BASIS FOR THE ISSUANCE OF A PERMIT.

GOTECH, INC.
8383 Bluebonnet Blvd.
Baton Rouge, LA 70810

ENGINEER: JOHN F. SCHENKNER
LICENSE # 33894
DATE: JUNE 10TH 2022

T:\PROJECTS\890 - RTA Interim Downtown Transit Hub\DRAWINGS\SHEETS\DESIGN\Elk_PL_1.dwg

NO.	DATE	REVISIONS

DESIGNED:	JFS
DRAWN:	HJS
CHECKED:	JAW
APPROVED:	JFS
SCALE:	1" = 10'
DATE:	JUNE 10, 2022

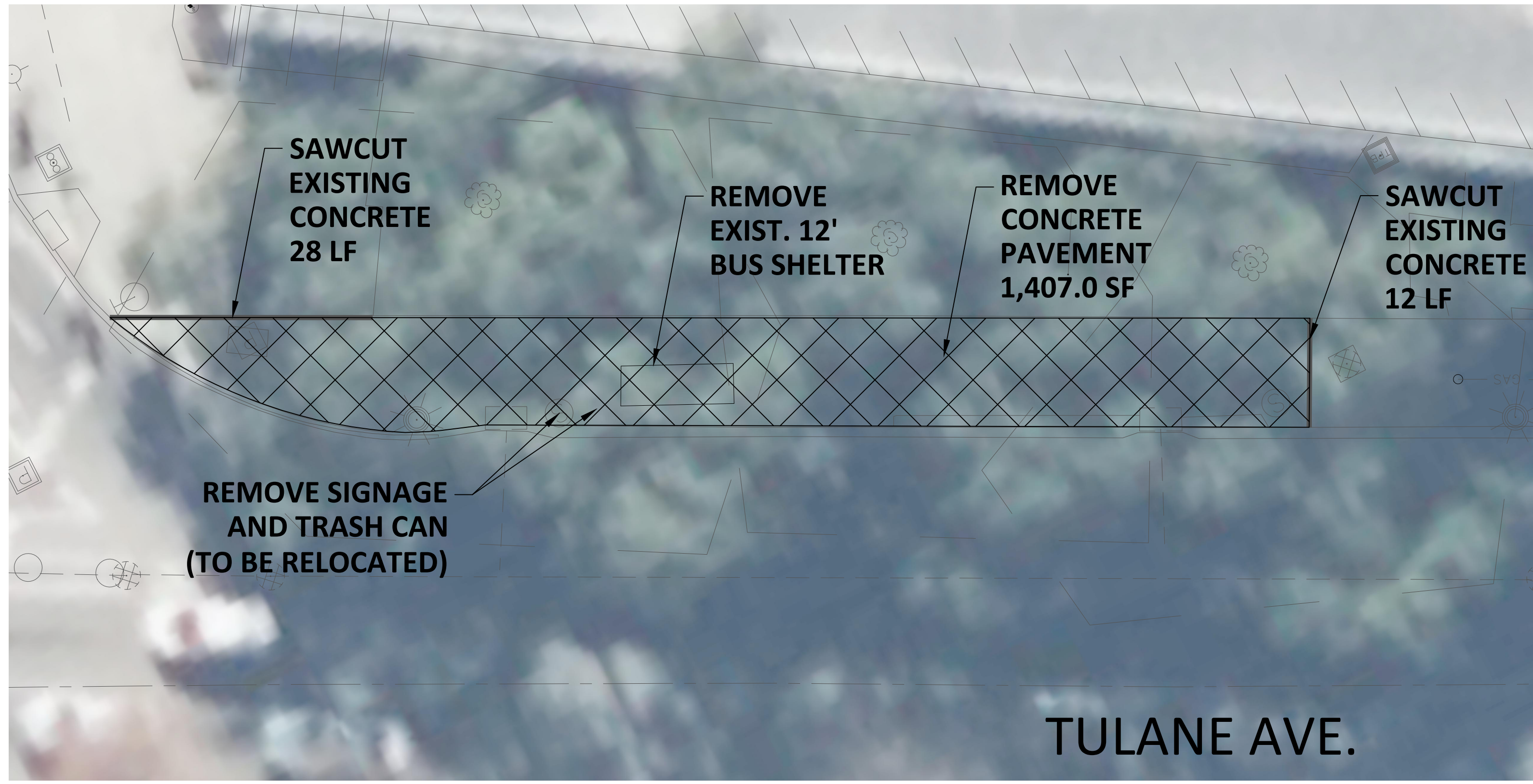

1 TULANE AVENUE DEMOLITION PLAN
Scale = 1"=10'

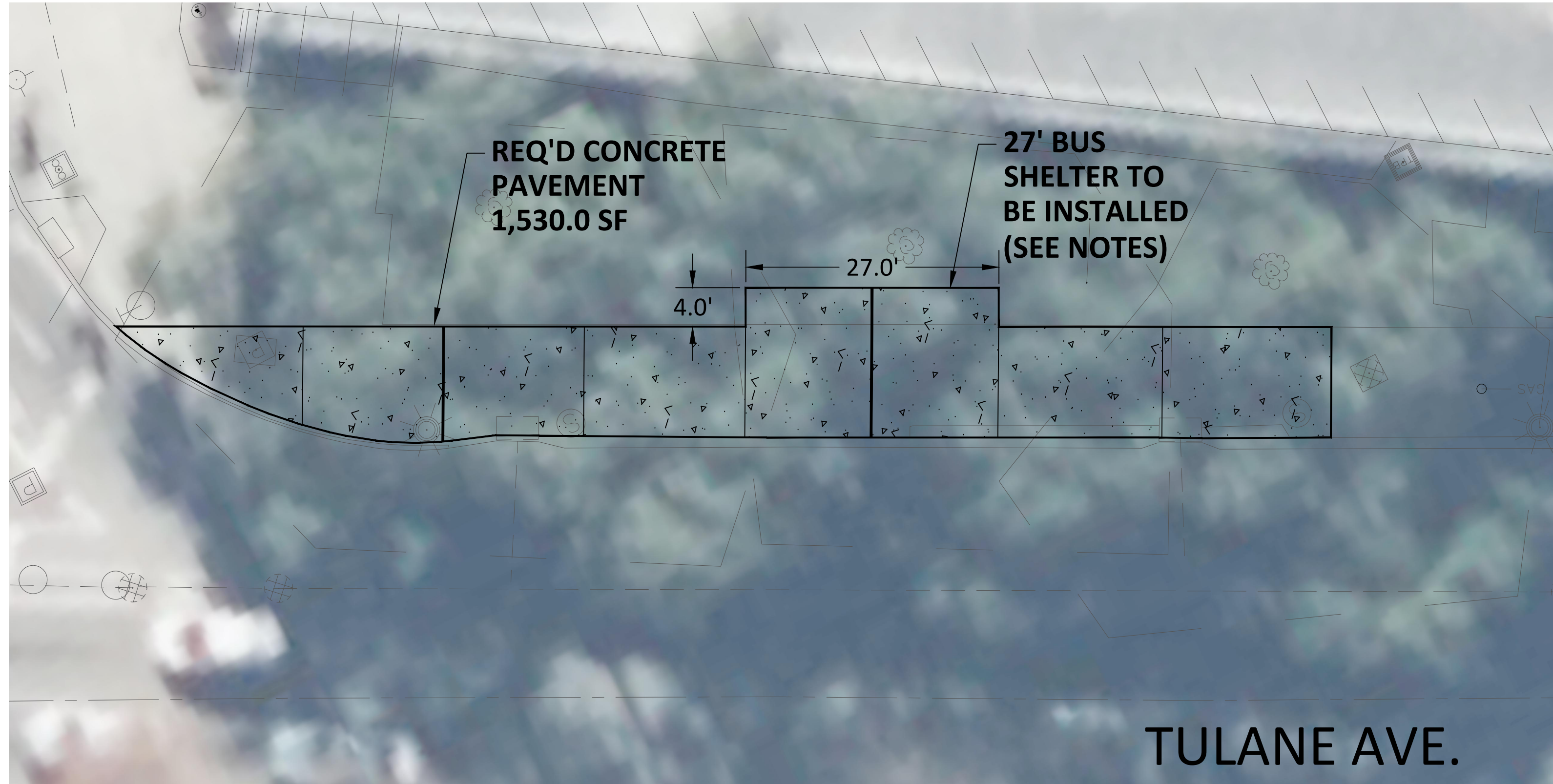

2 TULANE AVENUE PAVING PLAN
Scale = 1"=10'

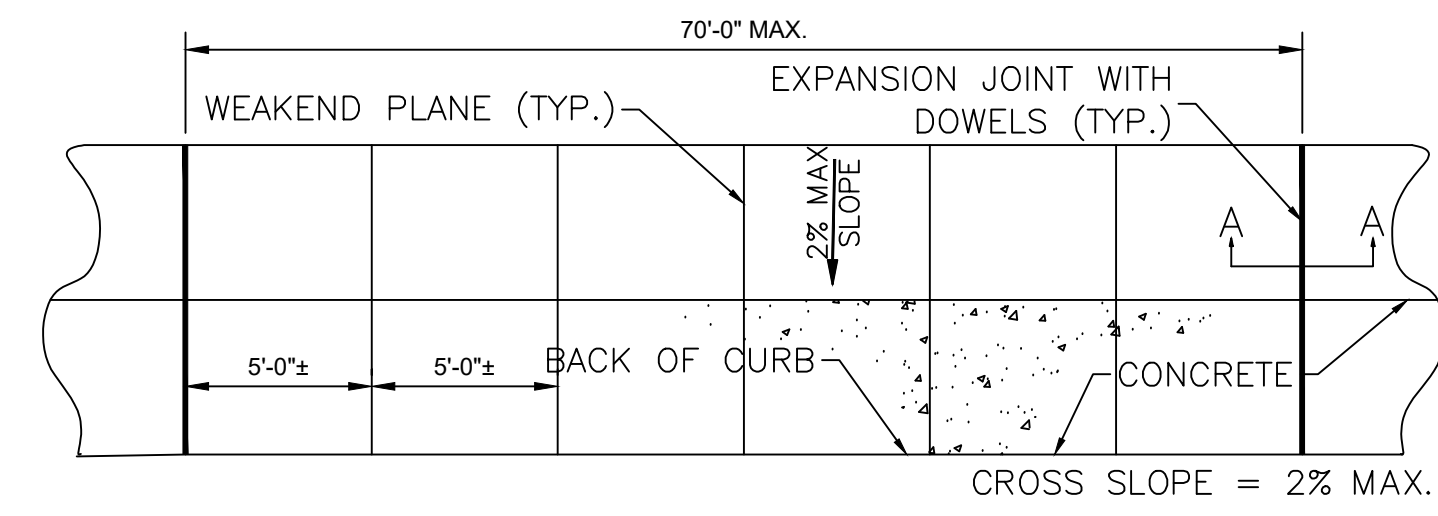

PLAN PORTLAND CEMENT CONCRETE SIDEWALK PAVEMENT (FULL)
N.T.S.

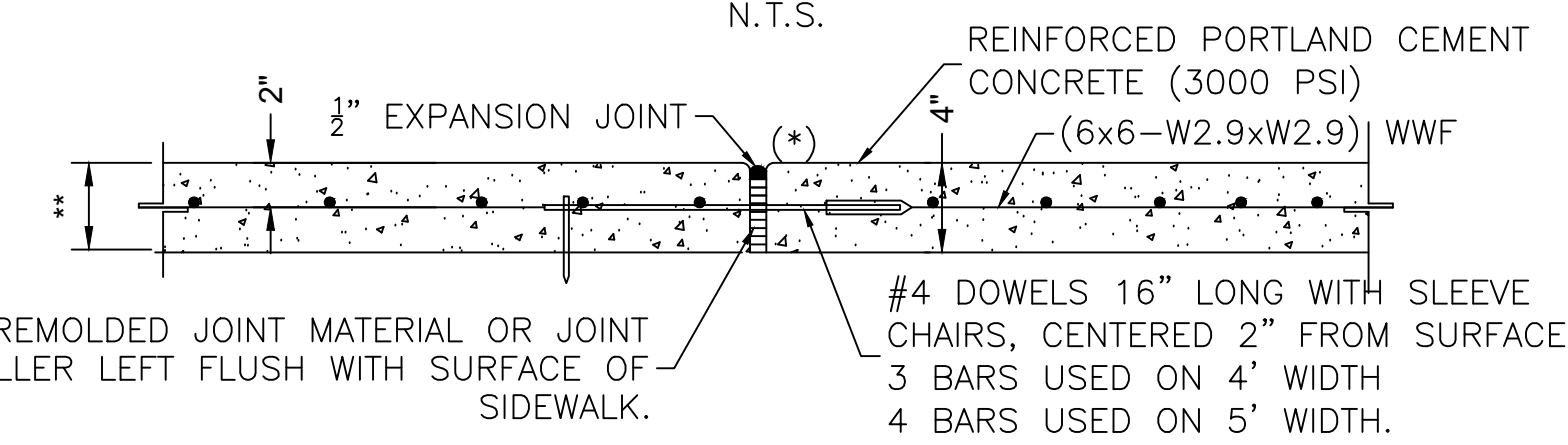

** CONCRETE PAVING THICKNESS TO BE 4" FOR SIDEWALKS AND 6" FOR DRIVES. SECTION A-A N.T.S. (*) THIS HALF OF DOWEL SHALL BE GREASED

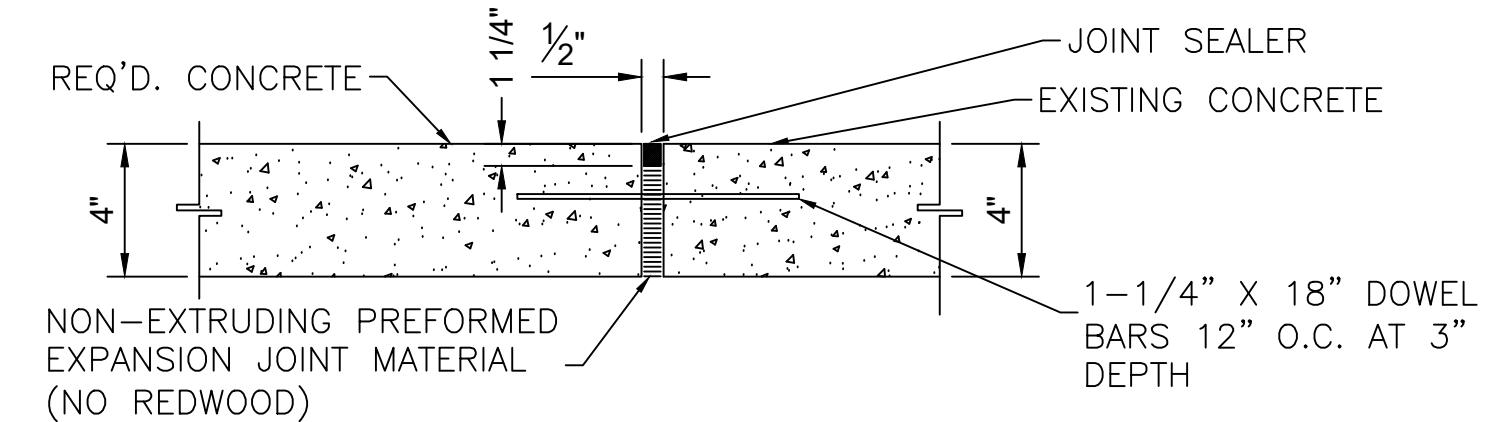

NOTE: CONSTRUCTION JOINT TO BE PLACED ALONG ALL EDGES OF NEW CONCRETE PAVEMENT PLACED AT EXISTING CONCRETE PAVEMENT.

NEW CONCRETE AT EXISTING CONCRETE
N.T.S.

3 SIDEWALK PAVING DETAILS
Scale = N.T.S.

TULANE AVENUE NOTES
SITE PLAN NOTES

- NEW ORLEANS RTA DOWNTOWN TRANSIT HUB - TULANE AVENUE SITE PLAN CONSISTS OF THE FOLLOWING:
 - PAVEMENT STRIPING ALONG OUTERMOST LANE OF EASTBOUND TULANE AVENUE TO INDICATE BUS ONLY TRAFFIC.
 - MODIFICATIONS TO NEW ORLEANS LIBRARY PARKING LOT CIRCULATION PLAN TO CREATE EXIT ONLY ON THE WESTERN DRIVE AND ENTRANCE ONLY ON THE EASTERN DRIVE.
 - SIDEWALK MODIFICATIONS FROM THE CORNER OF LOYOLA AVENUE THROUGH PROPOSED BUS SHELTER AREA, AS INDICATED. THIS WILL CREATE AN ADA-COMPLIANT SIDEWALK AREA.
 - ADD ALTERNATE FOR EXTENDED SIDEWALK REHABILITATION ALONG TULANE AVENUE THROUGH LIBRARY DRIVEWAYS, AS INDICATED.
 - INSTALLATION OF NEW 24' BUS SHELTER ALONG TULANE AVENUE.
 - RELOCATION OF EXISTING SIGNAGE, TRASH CAN, AND LIBRARY BOOK DROP OFF.
- ALL PAVEMENT STRIPING WORK TO BE COORDINATED WITH CITY OF NEW ORLEANS DEPARTMENT OF PUBLIC WORKS, 1300 PERDIDO STREET, ROOM 6W03, NEW ORLEANS, LA 70112, (504) 658-8000
- PAVEMENT STRIPING TO BE INSTALLED PER REQUIREMENTS OF CITY OF NEW ORLEANS DEPARTMENT OF PUBLIC WORKS DRAWING NO. PM1.
- RELOCATED TRASH CAN LOCATION SHOWN IS CONCEPTUAL. CONTRACTOR TO RELOCATE TRASH CAN TO THE WEST, AGAINST THE EXISTING BUILDING BASED ON MOST OPTIMAL SITE CONDITIONS. ACTUAL RELOCATION LOCATION TO BE APPROVED BY RTA PRIOR TO INSTALLATION.
- RELOCATED SIGNAGE LOCATION SHOWN IS CONCEPTUAL. CONTRACTOR TO RELOCATE SIGN IN GENERAL LOCATION AS INDICATED BASED ON MOST OPTIMAL SITE CONDITIONS. ACTUAL RELOCATION LOCATION TO BE APPROVED BY RTA PRIOR TO INSTALLATION.
- ALL WORK WITHIN LIBRARY PARKING AREA TO BE COORDINATED WITH NEW ORLEANS PUBLIC LIBRARIES (NOPL).

BUS SHELTER NOTES

- 27' BUS SHELTER TO BE PROVIDED BY RTA AT NO DIRECT COST TO CONTRACTOR.
- CONTRACTOR TO INSTALL BUS SHELTER PER RTA REQUIREMENTS IN THE INDICATED LOCATION.
- UPON REMOVAL OF EXISTING BUS SHELTER, CONTRACTOR TO RETURN SHELTER TO RTA. CONTRACTOR TO COORDINATE WITH RTA REGARDING RETURN LOCATION.
- NEW BUS SHELTER WILL BE PROVIDED BY RTA AT NO DIRECT COST TO CONTRACTOR.

SIDEWALKS NOTES

- ALL SIDEWALKS TO BE CONSTRUCTED PER CITY OF NEW ORLEANS DEPARTMENT OF PUBLIC WORKS MISCELLANEOUS DETAILS FOR STREET CONSTRUCTION - MC1.
- ADA RAMPS TO BE INSTALLED AT EACH DRIVEWAY INTERFACE. ALL ADA RAMPS TO BE CONSTRUCTED PER CITY OF NEW ORLEANS DEPARTMENT OF PUBLIC WORKS CURB RAMPS FOR STREET CONSTRUCTION ADA1 AND ADA2.

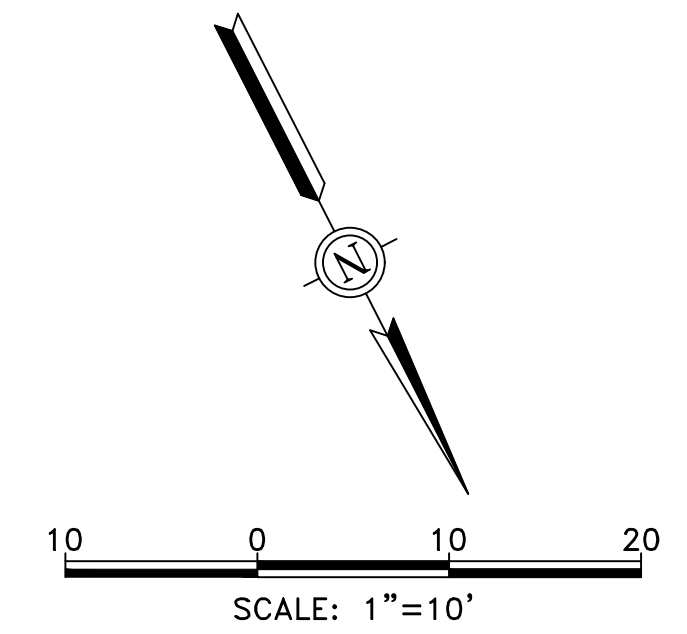

LEGEND

- ⊙ DRAIN MH
- ⊙ FIRE HYDRANT
- ☀ GENERAL LIGHT
- ⊗ GAS METER
- ⊕ GAS VALVE
- ⊙ MECHANICAL POINT
- ⊙ POWER TRANSFORMER
- ⊙ POWER VAULT
- ⊙ POWERPOLE
- ⊙ SEWER MANHOLE
- ⊗ SEWER CLEANOUT
- ⊙ SIGN
- ⊙ WATER VALVE
- ⊙ TREE
- S--- SEWER LINE
- E---E--- ELECTRIC LINE (BELOW GRD)
- P--- ELECTRIC LINE (ABOVE GRD)
- D---D--- DRAINAGE LINE (8" DIA. AND BELOW)
- === DRAINAGE LINE (10" DIA. AND ABOVE)
- G--- GAS LINE
- W--- WATER LINE
- X---X--- FENCE LINE
- 1/4" TOOLED JOINT
- EXPANSION JOINT

PRELIMINARY 90% DESIGN
NOT TO BE USED FOR CONSTRUCTION, BIDDING, RECORDATION, CONVEYANCE, SALES OR AS THE BASIS FOR THE ISSUANCE OF A PERMIT.
GOTECH, INC. 8383 Bluebonnet Blvd. Baton Rouge, LA 70810
ENGINEER: JOHN F. SCHENKNER LICENSE # 33894 DATE: JUNE 10TH 2022

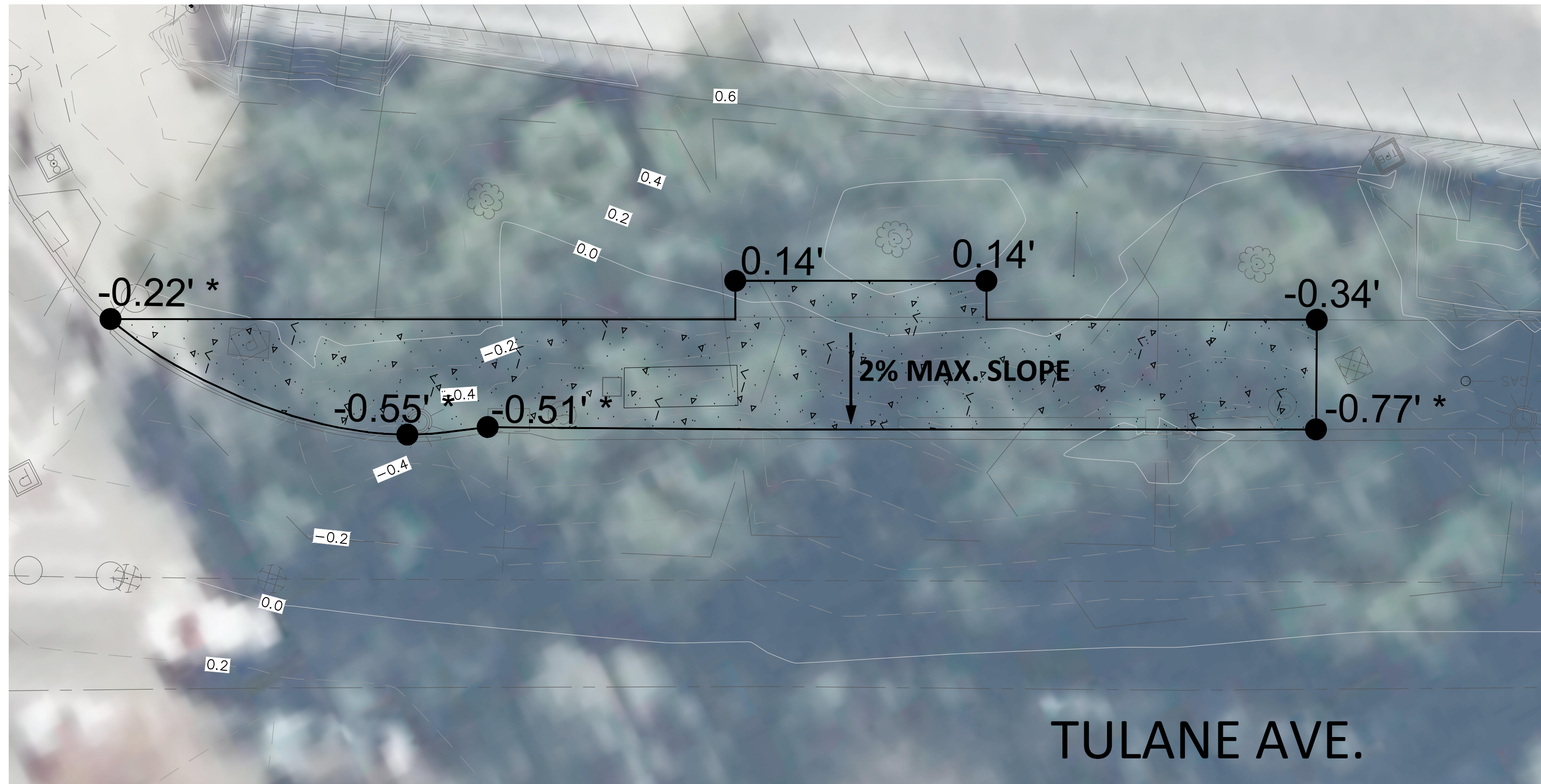

TULANE AVE.

4 TULANE AVENUE GRADING PLAN
Scale = 1"=10'

* APPROXIMATE ELEVATION SHOWN. ACTUAL TOP OF PAVEMENT TO MATCH EXISTING BACK OF CURB.

5 TULANE AVENUE SITE PLAN & PAVEMENT MARKING PLAN
Scale = 1"=10'

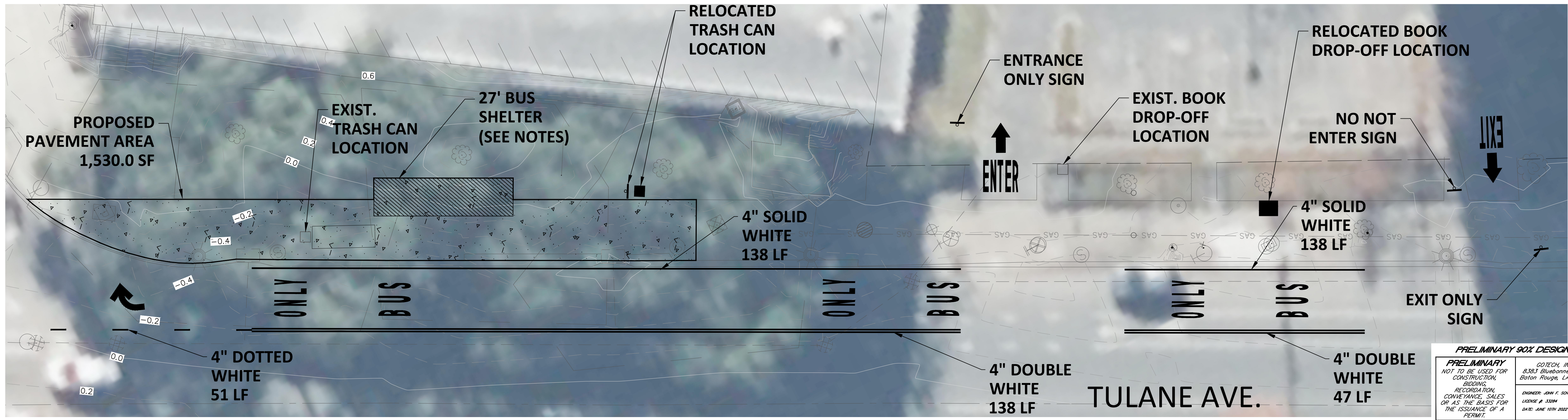

TULANE AVE.

PAVEMENT STRIPING NOTES

1. ALL PAVEMENT STRIPING WORK TO BE COORDINATED WITH THE CITY OF NEW ORLEANS DEPARTMENT OF PUBLIC WORKS, 1300 PERDIDO STREET, ROOM 6W03, NEW ORLEANS, LA 70112, (504) 658-8000.
2. PAVEMENT STRIPING TO BE INSTALLED PER REQUIREMENTS OF CITY OF NEW ORLEANS DEPARTMENT OF PUBLIC WORKS STANDARD DRAWINGS O.PM1.
3. ALL PAVEMENT MARKINGS SHALL BE RETROREFLECTIVE.
4. DOTTED LINE STRIPING SHALL CONSIST OF 3-FOOT LINE SEGMENTS AND 9-FOOT GAPS.
5. BUS ONLY SYMBOLS TO BE ELONGATED LETTERS 8-FEET LONG AND SHALL BE IN ACCORDANCE WITH THE DESIGN DETAILS OF THE PAVEMENT MARKINGS CHAPTER OF THE FHWA "STANDARD HIGHWAY SIGNS AND MARKINGS" (SECTION 1A.11). CURRENT EDITION.

BUS SHELTER NOTES

1. 27' BUS SHELTER TO BE PROVIDED BY RTA AT NO DIRECT COST TO CONTRACTOR.
2. CONTRACTOR TO INSTALL BUS SHELTER PER RTA REQUIREMENTS IN THE INDICATED LOCATION.

SIGNS NOTES

1. ALL SIGNS TO BE INSTALLED PER MANUAL ON UNIFORM TRAFFIC CONTROL DEVICES (MUTCD), CURRENT VERSION.
2. DO NOT ENTER SIGN MUST BE MUTCD X-R5-1
3. ENTRANCE ONLY SIGN TO BE MUTCD K-2897.

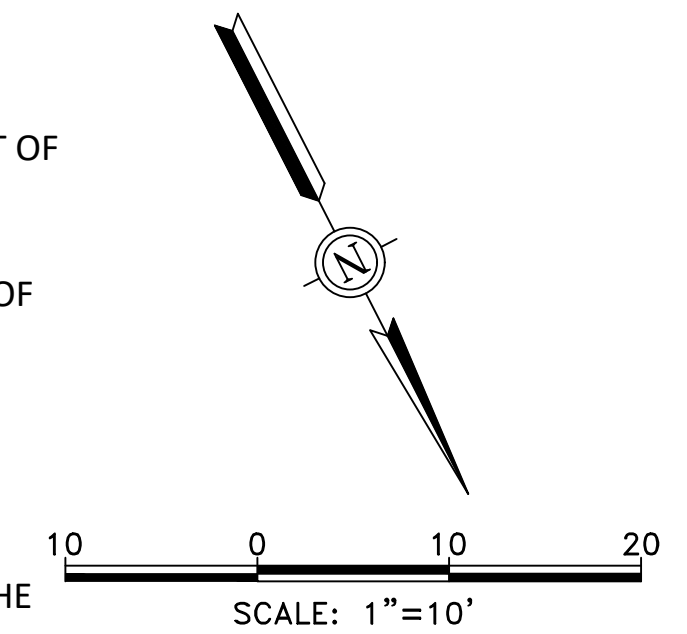

LEGEND

- ⊙ DRAIN MH
- ⊙ FIRE HYDRANT
- ☀ GENERAL LIGHT
- ⊗ GAS METER
- ⊕ GAS VALVE
- ⊙ MECHANICAL POINT
- ⊞ POWER TRANSFORMER
- ⊞ POWER VAULT
- ⊙ POWERPOLE
- ⊙ SEWER MANHOLE
- ⊗ SEWER CLEANOUT
- ⊞ SIGN
- ⊕ WATER VALVE
- 🌳 TREE
- S--- SEWER LINE
- E---E--- ELECTRIC LINE (BELOW GRD)
- P--- ELECTRIC LINE (ABOVE GRD)
- D---D--- DRAINAGE LINE (8" DIA. AND BELOW)
- ==== DRAINAGE LINE (10" DIA. AND ABOVE)
- G--- GAS LINE
- W--- WATER LINE
- X-X- FENCE LINE
- 30.00' PROPOSED SPOT GRADE

NO.	DATE	REVISIONS

G O T E C H , I N C .
CONSULTING ENGINEERS | 8383 BLUEBONNET BLVD. | BATON ROUGE, LA. 70810
PHONE: (225)766-5358 | FAX: (225)766-5879

DESIGNED:	JFS
DRAWN:	HJS
CHECKED:	JAW
APPROVED:	JFS
SCALE:	1" = 10'
DATE:	JUNE 10, 2022

PRELIMINARY 90% DESIGN
NOT TO BE USED FOR CONSTRUCTION, BIDDING, RECORDATION, CONVEYANCE, SALES OR AS THE BASIS FOR THE ISSUANCE OF A PERMIT.
GOTECH, INC.
8383 Bluebonnet Blvd.
Baton Rouge, LA 70810
ENGINEER: JOHN F. SCHENKNER
LICENSE # 33894
DATE: JUNE 10TH 2022

T:\PROJECTS\890 - RTA Interim Downtown Transit Hub\DRAWINGS\SHEETS\DESIGN\ Tulane Ave_2.dwg



1 TULANE AVENUE DEMOLITION PLAN
 Scale = 1"=10'

LEGEND

- ⊙ DRAIN MH
- ⊕ FIRE HYDRANT
- ☀ GENERAL LIGHT
- ⊗ GAS METER
- ⊕ GAS VALVE
- ⊕ MECHANICAL POINT
- ⊕ POWER TRANSFORMER
- ⊕ POWER VAULT
- ⊕ POWERPOLE
- ⊕ SEWER MANHOLE
- ⊕ SEWER CLEANOUT
- ⊕ SIGN
- ⊕ WATER VALVE
- ⊕ TREE

- S--- SEWER LINE
- E---E--- ELECTRIC LINE (BELOW GRD)
- P--- ELECTRIC LINE (ABOVE GRD)
- D---D--- DRAINAGE LINE (8" DIA. AND BELOW)
- ==== DRAINAGE LINE (10" DIA. AND ABOVE)
- G--- GAS LINE
- W--- WATER LINE
- X-X- FENCE LINE
- 1/4" TOOLED JOINT
- EXPANSION JOINT

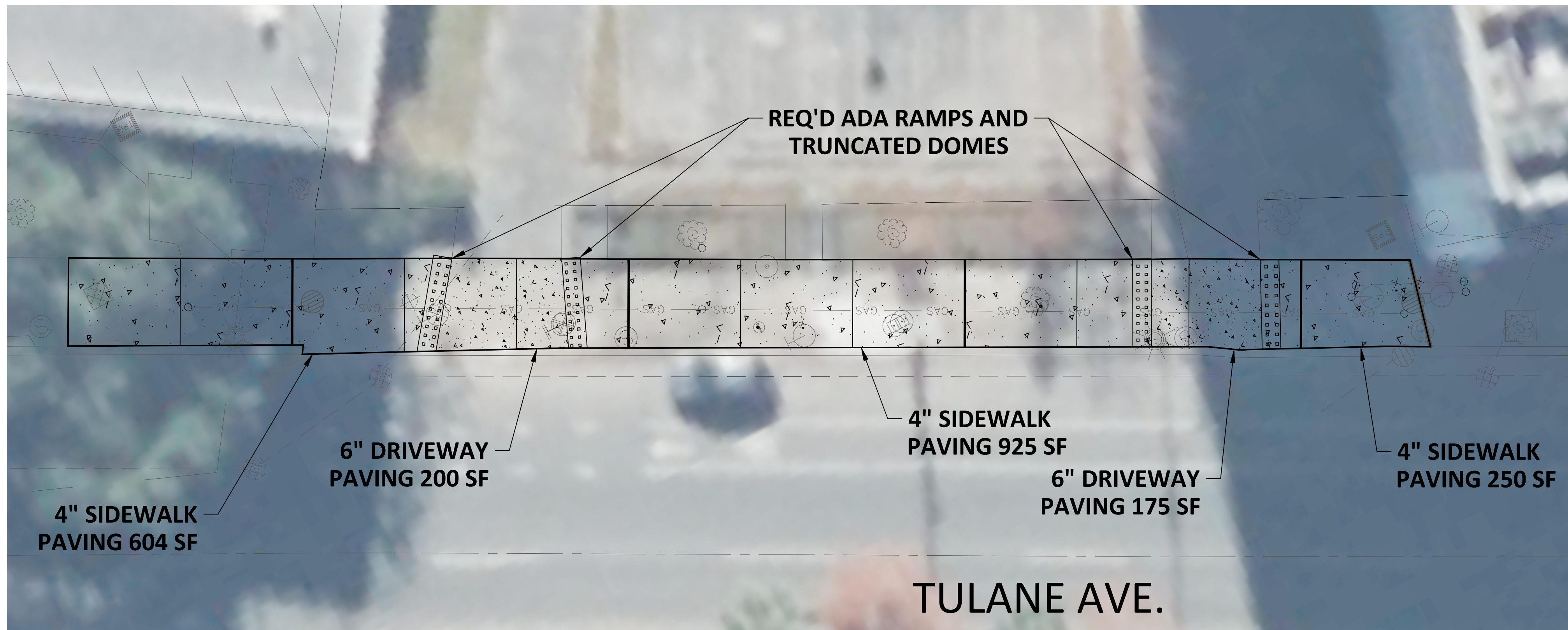
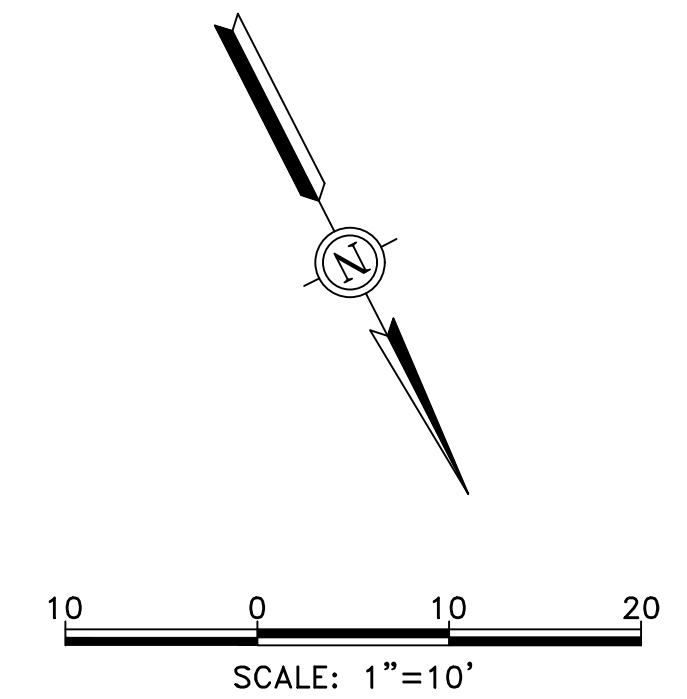

2 TULANE AVENUE PAVING PLAN
 Scale = 1"=10'

SIDEWALKS NOTES

1. ALL SIDEWALKS TO BE CONSTRUCTED PER CITY OF NEW ORLEANS DEPARTMENT OF PUBLIC WORKS MISCELLANEOUS DETAILS FOR STREET CONSTRUCTION - MC1.
2. ADA RAMPS TO BE INSTALLED AT EACH DRIVEWAY INTERFACE. ALL ADA RAMPS TO BE CONSTRUCTED PER CITY OF NEW ORLEANS DEPARTMENT OF PUBLIC WORKS CURB RAMPS FOR STREET CONSTRUCTION ADA1 AND ADA2.
3. SEE SHEET 4 FOR SIDEWALK PAVEMENT DETAILS.
4. ADA RAMPS AND TRUNCATED DOMES TO BE CONSTRUCTED IN ACCORDANCE WITH CITY OF NEW ORLEANS DEPARTMENT OF PUBLIC WORKS DRAWING NOS. ADA1 AND ADA2.

PRELIMINARY 90% DESIGN

NOT TO BE USED FOR CONSTRUCTION, BIDDING, RECORDATION, CONVEYANCE, SALES OR AS THE BASIS FOR THE ISSUANCE OF A PERMIT.

GOTECH, INC.
 8383 Bluebonnet Blvd.
 Baton Rouge, LA 70810

ENGINEER: JOHN F. SCHENKNER
 LICENSE # 33894
 DATE: JUNE 10TH 2022

NO.	DATE	REVISIONS

G O T E C H , I N C .

CONSULTING ENGINEERS | 8383 BLUEBONNET BLVD. | BATON ROUGE, LA. 70810
 PHONE: (225)766-5358 | FAX: (225)766-5879

DESIGNED:	JFS
DRAWN:	HJS
CHECKED:	JAW
APPROVED:	JFS
SCALE:	1" = 10'
DATE:	JUNE 10, 2022

T:\PROJECTS\890 - RTA Interim Downtown Transit Hub\DRAWINGS\SHEETS\DESIGN\Tulane Ave_AddAlternate.dwg

NO.	DATE	REVISIONS

DESIGNED:	JFS
DRAWN:	HJS
CHECKED:	JAW
APPROVED:	JFS
SCALE:	1" = 20'
DATE:	JUNE 10, 2022

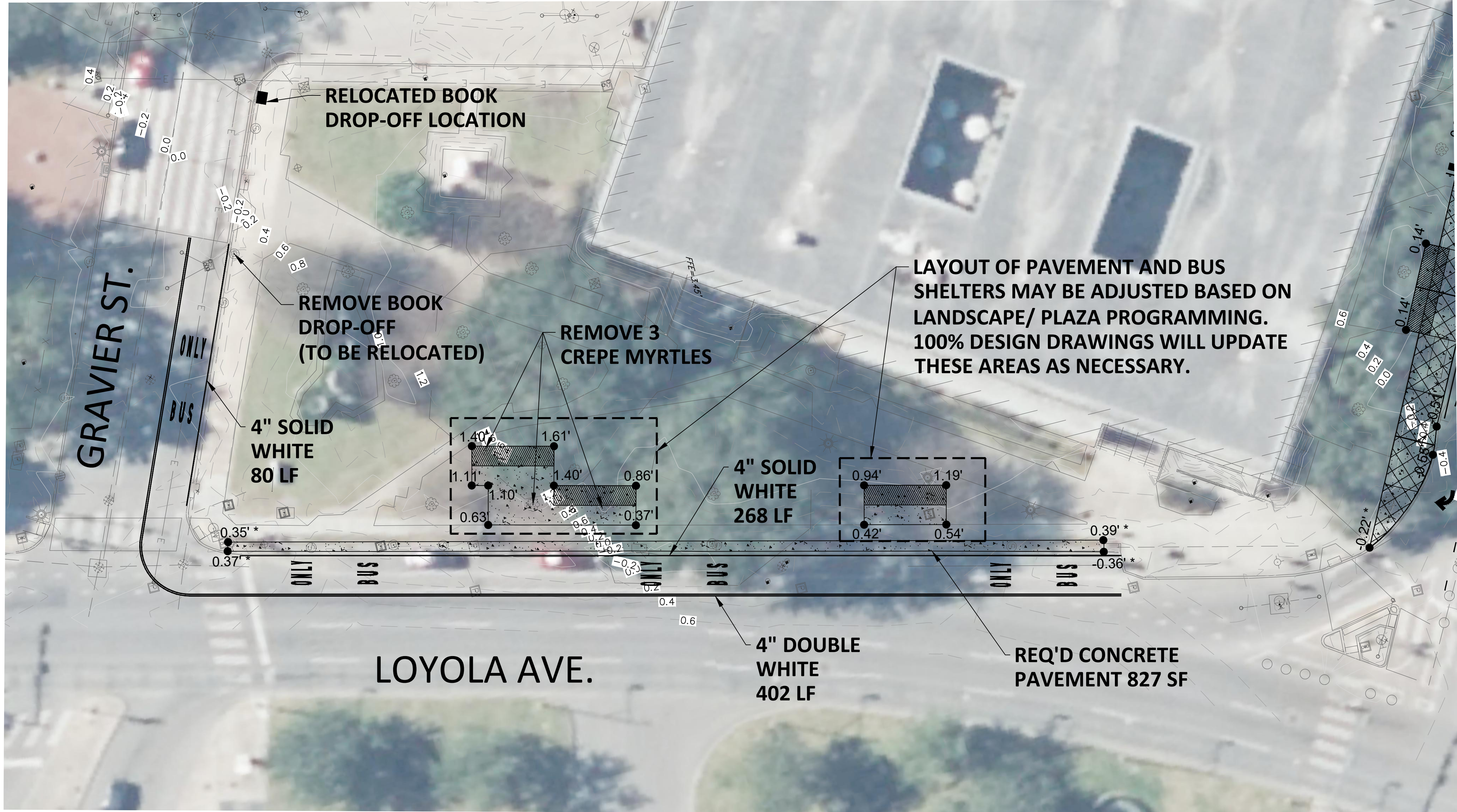

LEGEND

- ⊙ DRAIN MH
- ⊙ FIRE HYDRANT
- ☀ GENERAL LIGHT
- ⊗ GAS METER
- ⊕ GAS VALVE
- ⊙ MECHANICAL POINT
- ⊞ POWER TRANSFORMER
- ⊞ POWER VAULT
- ⊙ POWERPOLE
- ⊙ SEWER MANHOLE
- ⊞ SEWER CLEANOUT
- ⊙ SIGN
- ⊕ WATER VALVE
- ⊙ TREE

--- S --- SEWER LINE
 --- E --- E --- ELECTRIC LINE (BELOW GRD)
 --- P --- ELECTRIC LINE (ABOVE GRD)
 --- D --- D --- DRAINAGE LINE (8" DIA. AND BELOW)
 --- G --- DRAINAGE LINE (10" DIA. AND ABOVE)
 --- W --- GAS LINE
 --- X --- X --- WATER LINE
 --- X --- X --- FENCE LINE

● 30.00' PROPOSED SPOT GRADE

* APPROXIMATE ELEVATION SHOWN. ACTUAL TOP OF PAVEMENT TO MATCH EXISTING BACK OF CURB.

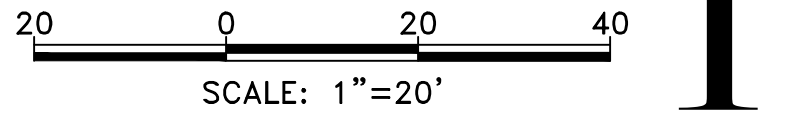

1 LOYOLA AVENUE & GRAVIER STREET SITE PLAN
Scale = 1"=20'

LOYOLA AVENUE NOTES

- SITE PLAN NOTES**
- NEW ORLEANS RTA DOWNTOWN TRANSIT HUB - LOYOLA AVENUE SITE PLAN CONSISTS OF THE FOLLOWING:
 - PAVEMENT STRIPING ALONG LOYOLA AVENUE TO INDICATE BUS ONLY TRAFFIC
 - EXTENSION OF EXISTING SIDEWALK FROM EXISTING SIDEWALK TO BACK OF CURB.
 - INSTALLATION OF 2 - 24' BUS SHELTERS ALONG LOYOLA AVENUE.
 - SIDEWALK PAVING TO FACILITATE NEW BUS SHELTERS.
 - INSTALLATION OF NEW 24' BUS SHELTER ALONG TULANE AVENUE.
 - ALL PAVEMENT STRIPING WORK TO BE COORDINATED WITH CITY OF NEW ORLEANS DEPARTMENT OF PUBLIC WORKS, 1300 PERDIDO STREET, ROOM 6W03, NEW ORLEANS, LA 70112, (504) 658-8000
 - PAVEMENT STRIPING TO BE INSTALLED PER REQUIREMENTS OF CITY OF NEW ORLEANS DEPARTMENT OF PUBLIC WORKS DRAWING NO. PM1.
- BUS SHELTER NOTES**
- 27' BUS SHELTER TO BE PROVIDED BY RTA AT NO DIRECT COST TO CONTRACTOR.
 - CONTRACTOR TO INSTALL BUS SHELTER PER RTA REQUIREMENTS IN THE INDICATED LOCATION.
 - NEW BUS SHELTER WILL BE PROVIDED BY RTA AT NO DIRECT COST TO CONTRACTOR.

- SIDEWALKS NOTES**
- ALL SIDEWALKS TO BE CONSTRUCTED PER CITY OF NEW ORLEANS DEPARTMENT OF PUBLIC WORKS MISCELLANEOUS DETAILS FOR STREET CONSTRUCTION - MC1.
 - ADA RAMPS TO BE INSTALLED AT EACH DRIVEWAY INTERFACE. ALL ADA RAMPS TO BE CONSTRUCTED PER CITY OF NEW ORLEANS DEPARTMENT OF PUBLIC WORKS CURB RAMPS FOR STREET CONSTRUCTION ADA1 AND ADA2.
- PAVEMENT STRIPING NOTES**
- ALL PAVEMENT STRIPING WORK TO BE COORDINATED WITH THE CITY OF NEW ORLEANS DEPARTMENT OF PUBLIC WORKS, 1300 PERDIDO STREET, ROOM 6W03, NEW ORLEANS, LA 70112, (504) 658-8000.
 - PAVEMENT STRIPING TO BE INSTALLED PER REQUIREMENTS OF CITY OF NEW ORLEANS DEPARTMENT OF PUBLIC WORKS STANDARD DRAWINGS O.PM1.
 - ALL PAVEMENT MARKINGS SHALL BE RETROREFLECTIVE.
 - DOTTED LINE STRIPING SHALL CONSIST OF 3-FOOT LINE SEGMENTS AND 9-FOOT GAPS.
 - BUS ONLY SYMBOLS TO BE ELONGATED LETTERS 8-FOOT LONG AND SHALL BE IN ACCORDANCE WITH THE DESIGN DETAILS OF THE PAVEMENT MARKINGS CHAPTER OF THE FHWA "STANDARD HIGHWAY SIGNS AND MARKINGS" (SECTION 1A.11). CURRENT EDITION.

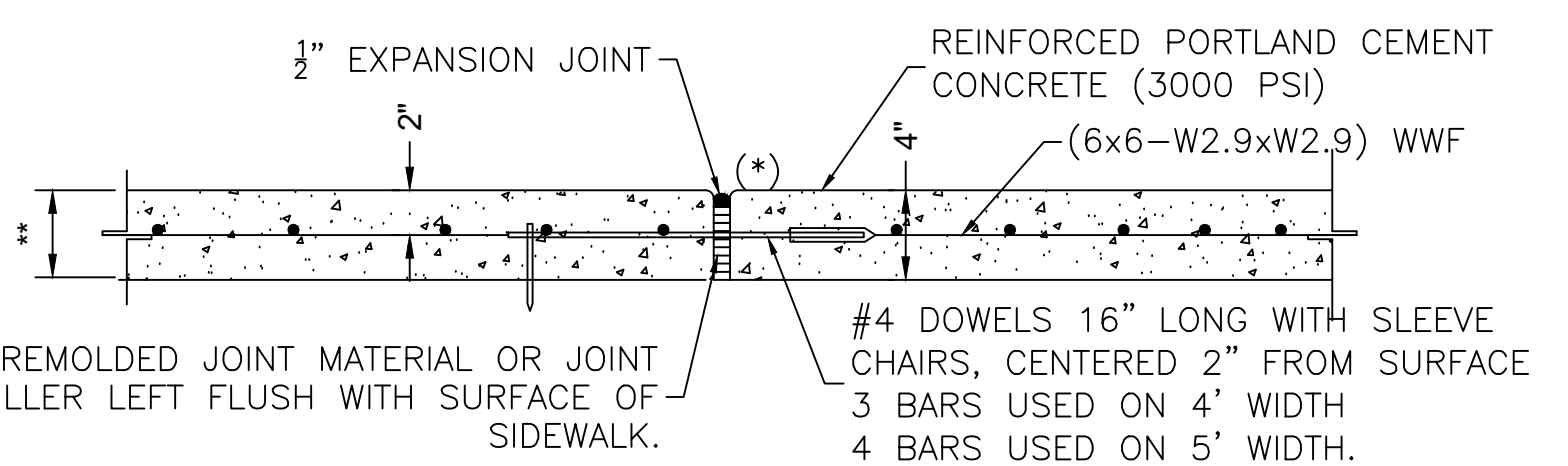
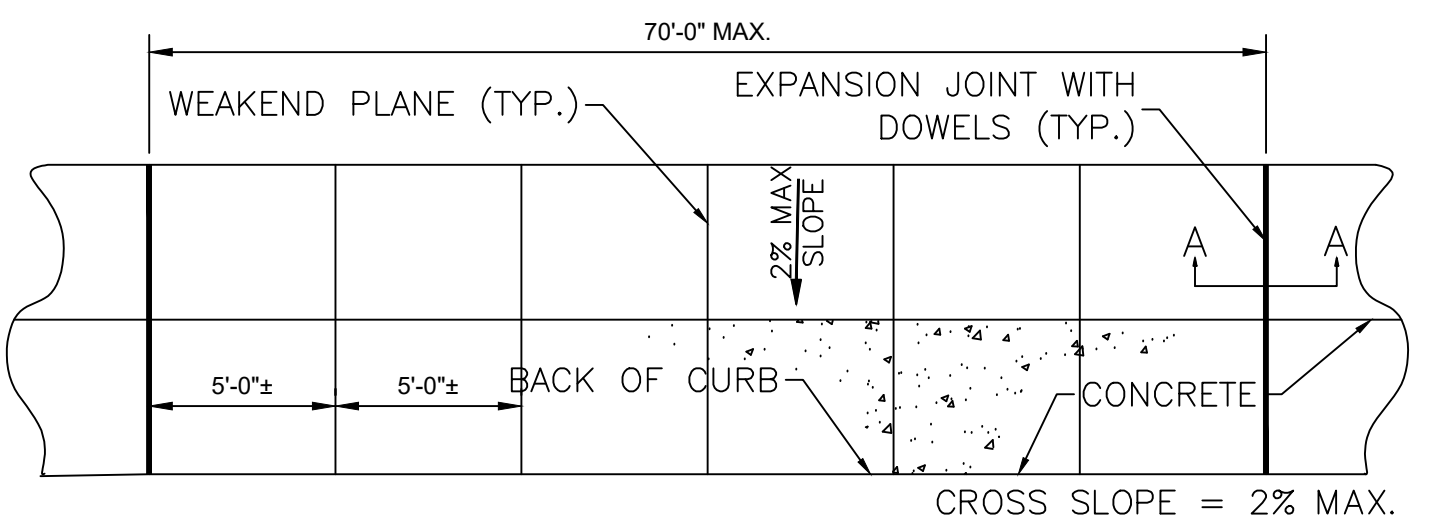

** CONCRETE PAVING THICKNESS TO BE 4" FOR SIDEWALKS AND 6" FOR DRIVES. SECTION A-A (*) THIS HALF OF DOWEL SHALL BE GREASED

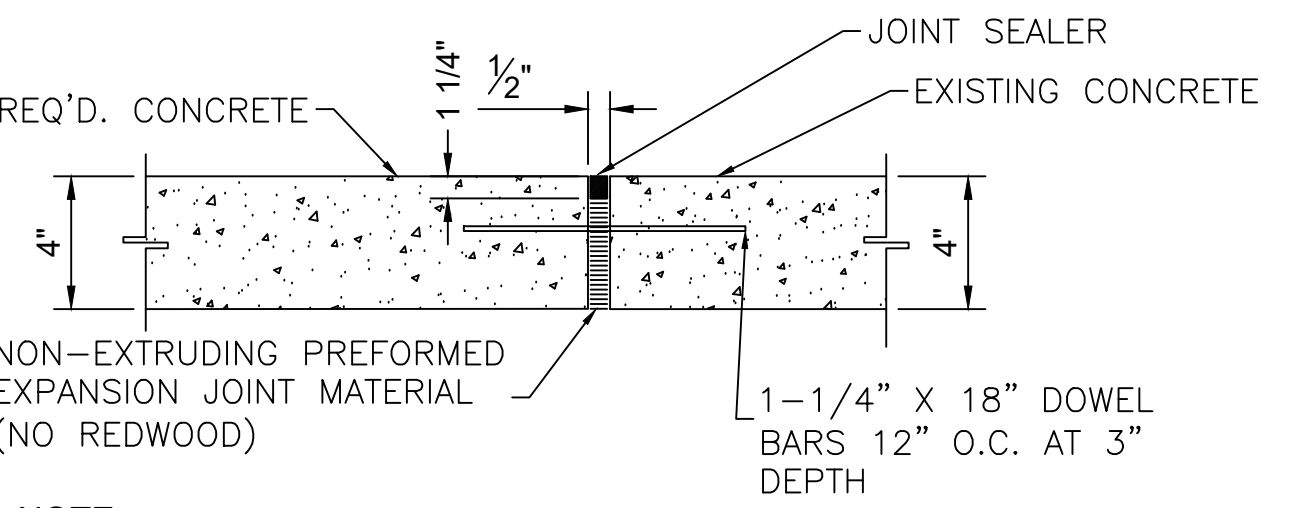

NOTE: CONSTRUCTION JOINT TO BE PLACED ALONG ALL EDGES OF NEW CONCRETE PAVEMENT PLACED AT EXISTING CONCRETE PAVEMENT.

2 SIDEWALK PAVING DETAILS
Scale = N.T.S.

PRELIMINARY 90% DESIGN

NOT TO BE USED FOR CONSTRUCTION, BIDDING, RECORDATION, CONVEYANCE, SALES OR AS THE BASIS FOR THE ISSUANCE OF A PERMIT.

GOTECH, INC.
8383 Bluebonnet Blvd.
Baton Rouge, LA 70810
ENGINEER: JOHN F. SCHENKMEYER
LICENSE # 33894
DATE: JUNE 10TH 2022

T:\PROJECTS\890 - RTA Interim Downtown Transit Hub DRAWINGS\SHEETS\DESIGN\Loyola Ave.dwg