



**Regional Transit Authority
State Contract Procurement Routing Sheet
For Transactions Over \$25,000**

INSTRUCTION: The user department is responsible for providing all information requested below and securing the requisite signatures.

Attachments (*Indicates Required Items)	
* Scope of Work	Project Schedule/Delivery Date *
Technical Specifications	Selection Criteria (RFQ/RFP Only)
DBE/SBE Goal Calculation	

A. I have reviewed this form and the attachments provided and by signing below I give authority to the below stated Department Representative to proceed as lead in the procurement process.

<u>Ryan Moser</u>	<u>Maint manager</u>	<u>8400</u>
Name	Title	Ext
<u>Billie J. Johnson</u>	<u>5/10/2021</u>	
Department Head Signature	Date	

B. Name of Project, Service or Product: Paratransit Vehicle purchase

C. Justification of Procurement: To establish a PO in line with the state contract for the purchase of paratransit vehicles. To be purchased on the State of Oklahoma Contract SW0797C. This procumbent is for the replacement of 21 paratransit vehicles that have outlived their useful life.

D. Certification of Authorized Grant:

Is this item/specification consistent with the Authorized Grant?	<input checked="" type="radio"/> Yes	<input type="radio"/> No
<u>Rasmul Van</u>	<u>5/10/2021</u>	
Director of Grants/ Federal Compliance	Date	

E. Safety: Include Standard Safety Provisions Only

<u>Michael J. Smith</u>	<u>5/11/21</u>
Safety Director	Date

Risk Management: Include Standard Insurance Provisions Only? Yes No

<u>[Signature]</u>	<u>5/12/2021</u>
Risk Management Analyst	Date



F. Funding Source: Federal State Local Other: _____

Funds are specifically allocated in the Department's current fiscal year budget or in a grant to cover this expenditure as follows:

Total Amount Available \$ 5,250,000

Projected Cost \$ \$2,238,453.00

Previous Cost (if applicable) \$ _____

FTA Grant No.(s) LA2021-014.1113.111215

Line Item(s) _____

Operations/Department Code _____

Budget Code(s) _____

NK
Budget Analyst _____ Date _____

G. DBE/SBE Goal: 0 % DBE _____ % Small Business

NK
Director of Small Business Development _____ Date _____

Kozjak P. Cauthorne
DBE/EEO Compliance Manager _____ Date 5/10/2021

H. Authorizations: I have reviewed and approved the final solicitation document.

Billie J. Johnson

Department Head Signature _____ Date 5/10/2021

Therese E. Strick
Division Manager _____ Date 5/12/21

Ronald M. Byrd
Director of Procurement _____ Date 5/17/21

FOR PROCUREMENT USE ONLY

Type of Procurement Requested: (circle one) IFB RFQ RFP SS SC TWO-STEP

Invitation for Bid (IFB) This competitive method of awarding contracts is used for procurements of more than \$25,000 in value. The agency knows exactly what and how many of everything it needs in the contract, as well as when and how the products and services are to be delivered. The award is generally based on price.

Request for Quote (RFQ) This type of solicitation is often used to determine current market pricing.

Request for Proposal (RFP) This approach to contracting occurs when the agency isn't certain about what it wants and is looking to you to develop a solution and cost estimate.

Sole Source (SS) this procurement can be defined as any contract entered into without a competitive process, based on a justification that only one known source exists or that only one single supplier can fulfill the requirements.

State Contract (SC) this procurement is via a State competitive procurement

Two-step Procurement - request for qualifications step-one used in the formal process of procuring a product or service, It is typically used as a screening step to establish a pool of vendors that are then qualified, and thus eligible to submit responses to a request for price proposal (RFP). In this two-step process, the response to the RFQ will describe the



company or individual's general qualifications to perform a service or supply a product, and RFP will describe specific details or price proposals.

Dezelle Johnson-Parker (MAM)

Chief Financial Officer

[Signature]

Chief Executive Officer

5-17-2021

Date

5-17-21

Date



To: **Billie J. Johnson, Director of Mobility and Alternative Modes**

From: Mike Smith, Chief Safety Officer

Date: May 11, 2021

RE: **Procurement of 21 Paratransit Vehicles**

In reference to the proposed procurement of 21 paratransit vehicles;

- The vendor is requested to provide detailed, technical specifications and drawings concerning the “driver’s barrier kit” as listed under “other available options,” after which RTA will have a review period of no less than five (5) business days to review the final design prior to installation.
- The manufacturer installation of the Seon video system, including all cameras, wiring, harnesses, braces/brackets, and other hardware, shall conform to RTA requirements.

Independent Cost Estimate (ICE)

INDEPENDENT COST ESTIMATE SUMMARY FORM

Project Name/Number:

Date of Estimate:

Description of Goods/Services:

Port transit Vehicle Purchase

- New Procurement
- Contract Modification (Change Order)
- Exercise of Option

Method of Obtaining Estimate: Estimate based on price received by NICE Bus solicitation number E3263R for similar item.

Attach additional documentation such as previous pricing, documentation, emails, internet screen shots, estimates on letterhead, etc.

- Published Price List (attach source and date)
- Historical Pricing (attach copy of documentation from previous PO/Contract)
- Comparable Purchases by Other Agencies (attach email correspondence)
- Engineering or Technical Estimate (attach)
- Independent Third-Party Estimate (attach)
- Other (specify) _____ attach documentation
- Pre-established pricing resulting from competition (Contract Modification only)

Through the method(s) stated above, it has been determined the estimated

total cost of the goods/services is \$ 2,238,453

The preceding independent cost estimate was prepared by:

Ryan Moser

Name

[Signature]

Signature



12/16/2020

Dear Awarded Supplier,

Oklahoma Statewide Contract SW797C was awarded with the base agreement period commencing 02/01/2020 and ending 01/31/2024 with 3 options to renew for one-year periods. The State of Oklahoma is requesting to renew the above contract for the period of 02/01/2021 through 01/31/2022.

Please indicate your firm's response to this request and return by email.

- Yes, our firm will renew the contract pricing and terms on the above listed contract.
 No, our firm will not renew the contract pricing and terms on the above listed contract.

Federal Employer / Tax Identification Number: 33-0388707

PeopleSoft Identification Number: _____

Company Name: Creative Bus Sales, Inc.

Address: 14740 Ramona Ave.

City: Chino State: CA

Zip Code: 91710

Email: marcush@creativebussales.com

Marcus Hoffman, Bid Manager
Name / Title

12/23/2020
Date

Signature

Send response electronically to the email address below of the contracting officer by: January 4, 2021

Contracting Officer Name: Carol Williams-Downing

Contracting Officer Phone: (405) 522 - 0432

Contracting Officer Email Address: Carol.williamsdowning@omes.ok.gov

OMES FORM CP 228 – Rev. 02/2020



State of Oklahoma Contract

SW0797C

FY 2020

Preparer: Micah Bailey

Base Model
Starcraft Allstar 7.3L V8 Gas 176" WB 12,500 GVWR

Base Model Price: \$ 65,227.00

Options: \$ 344.00

Other Available Options: \$ 1,609.00

Unpublished Options: \$ 39,413.00



Vehicle Length	Lift Position	WC Positions	Total # Passengers	CDL Required
279"	Rear	4	14	No

QTY Vehicles: Total Contract Price:

Per Vehicle Price: \$ 106,593.00

Customer Info

Customer:	Regional Transit Authority
Address:	287 Canal St New Orleans, LA 70119
Contact:	Jacques Robichaux
Office Phone:	(504) 248-3900
Mobile Phone:	
E-Mail:	jrobichaux@rtaforward.org

Floorplan

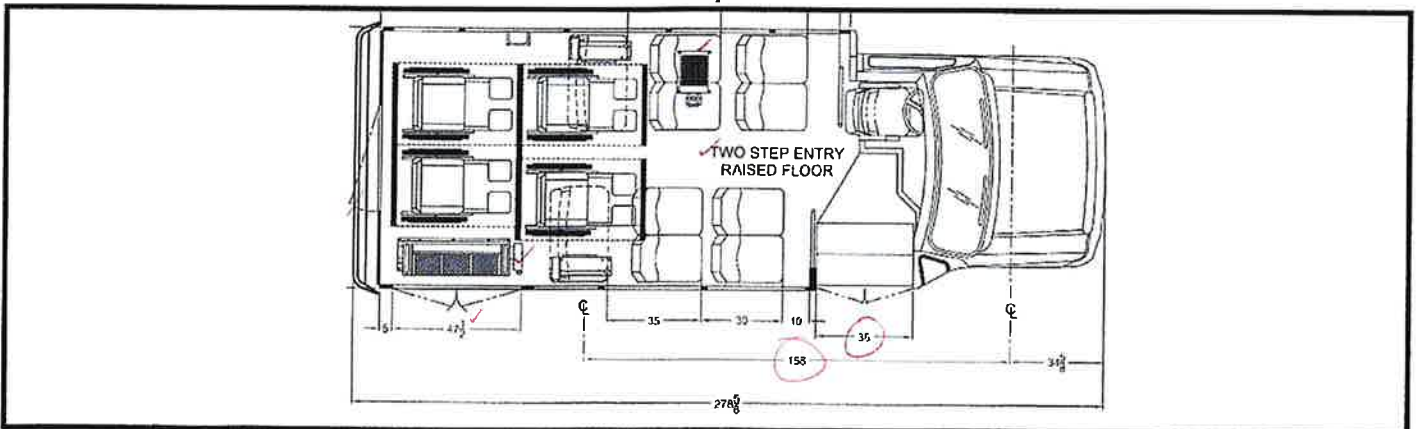



OPTIONS

Type E - 24' 15 Passenger Rear Lift

Qty	Description	FY 2020 List Price	QTY Total
2	Freedman Seating TDSS (or equivalent) Fold Away Seat	\$ 150.00	\$ 300.00
2	Extra Seat Belt Extension	\$ 22.00	\$ 44.00
Subtotal Manufacturer Options:			\$ 344.00



OTHER AVAILABLE OPTIONS

Type E - 24' 15 Passenger Rear Lift

Qty	Description	FY 2020 List Price	QTY Total
1	Delete B-pillar and co-pilot seat	\$ (186.00)	\$ (186.00)
	Seagate 500GB 7200 RPM 2.5 in. SATA-HDD (500 GB SATA HDD)	\$ 124.00	\$ -
	Seagate Momentus 1TB 5400 RPM 2.5" SATA 3.0Gb/s (1TB SATA HD)	\$ 149.00	\$ -
	Automatic Download Software Ver 3.X (1 license per asset) - 1XFEE - Used with h.264-WIFI-N radio for WiFi network connectivity - offload video files over the WiFi network upon connection (ADSV3CAL)	\$ 108.95	\$ -
	HEALTH & SAFETY/DECONTAMINATION EQUIPMENT OPTIONS	See below	
	AeroClave RDS 3110T Decontamination kit (Incl. RDS 3110T, APA, Tripod, Data Logger, and shipping to end user)	\$ 15,507.00	\$ -
	AeroClave ADS On Board Decontamination System (incl. Compressor and Data Logger, shipping)	\$ 8,599.00	\$ -
	Installation of ADS system in vehicle	\$ 400.00	\$ -
	ADP-EX Kit	\$ 599.00	\$ -
	Installation of ADP-EX kit in vehicle	\$ 250.00	\$ -
	Additional APA portable applicator (ea.)	\$ 1,264.00	\$ -
	Additional tripod for APA applicator	\$ 129.00	\$ -
	ADP-AS Dual Headed Hose	\$ 814.00	\$ -
	Data logging module	\$ 850.00	\$ -
	Case of Vital Oxide Solution incl. shipping (4 Gallons)	\$ 140.00	\$ -
	55-gallon drum of Vital Oxide Solution incl. shipping	\$ 1,375.00	\$ -
	Pallet of Vital Oxide Solution (four (4) 55-gallon drums) incl. shipping	\$ 5,170.00	\$ -
		\$ 1,795.00	\$ 1,795.00
1	Driver's Barrier kit for E450 cutaway buses (single door or dual door) incl. shipping		
	Add sliding door option to Driver's Barrier (requires Driver's Barrier kit)	\$ 350.00	\$ -
	Installation of driver's barrier kit (per vehicle)	\$ 300.00	\$ -
		Subtotal Manufacturer Options:	\$ 1,609.00



CBS UNPUBLISHED OPTIONS

Type E - 24' 15 Passenger Rear Lift

Qty	Description	FY 2020 List Price	QTY Total
1	Two Way Radio from BearComm New Orleans	\$ 5,663.00	\$ 5,663.00
1	Seon Camera System to Match Current Route Buses	\$ 11,850.00	\$ 11,850.00
1	Full Custom Paint and Graphics	\$ 9,500.00	\$ 9,500.00
1	36 Month/ 36,000 Miles Warranty	\$ 650.00	\$ 650.00
1	First Aid Kit in Metal Container	\$ 100.00	\$ 100.00
1	Mor/Ryde RL Rear Suspension	\$ 1,200.00	\$ 1,200.00
2	Two Three Step Foldaway Doubles	\$ 950.00	\$ 1,900.00
1	Clever ROM Controller Installed at Cupholder Area	\$ 6,500.00	\$ 6,500.00
1	Installation of ROM by Clever	\$ 2,050.00	\$ 2,050.00
1	Side Barrier Kit Installed at Aisle Stanchion Poles		\$ -
Subtotal CBS Unpublished Options:			\$ 39,413.00

Texas Office:
4955 Northgate Dr
Irving, TX 75062
Phone: 940-391-7113



Creative Bus Sales

4/29/2021

2021 Starcraft Allstar on Ford E350 Chassis
12 Seated or 4 Wheelchair
Option Content for: New Orleans Regional Transit Authority

ALLSTAR - FORD E350					1
Allstar 22' 158" WB E-350 5.4L Gas W/225 AMP OEM ALT	ST	2907	C		1
SPECIAL INSTRUCTIONS OR NOTES					1
WARRANTY 36 MONTHS / 36,000 MILES					1
Tailpipe Straight Out the back on Curbside					1
Switch Panel Mounted Up High So Cup Holder Is Open					1
Pictures of Battery Box Approved 4-27-21					1
Custom Paint See Attached (Paint Codes Gray N1960EX, Purple N5750EX)					1
Use Rear Cap with 7" Round Light Pocket					1
SPECIAL BUILD ORDER					1
FLEX TECH ELECTRICAL SYSTEM	ST	0599			1
STANDARD ROSCO STSK4750 BACK-UP CAMERA SYSTEM W/ 7" REARVIEW	ST	0599			1
EXTERIOR SIDEWALLS REQUIRE AZDEL BACKER	ST	0599			1
Align with Caster/Camber Kit Send Printout with Each Vehicle	ST	0599			1
FlexTech, PRPC Fast Idle W/Interlock, With Complete Display	ST	0599			1
Extra Battery Box Key	ST	0599			1
PRPC PROGRAMMING/ FLEXTech FOR ELECTRIC ENTRANCE DOOR PARK	ST	0599			1
Extra Tailpipe Hangers	ST	0599			2
Pre Wire Battery Hot, Ignition, Ground Terminate at Right Side of Doghouse (36" Wire Loop) for BearComm Motorola Radio	ST	0599			1
Decal on Rearview Monitor "Requires a Spotter" Very Small	ST	0599			1
One Piece Coved Entry Steps Flooring (PER STEP)	ST	0599			4
L-Track on Wall in 2 Section of 24" on Streetside Wall in LH WC Position	ST	0599			4
SEON Camera System	ST	0599			1
SIDEWALL / REARWALL / CEILING					1
Sidewall: Grey FRP	05	STD			1
Driver Area: Grey Padded Vinyl	05	STD			1
FRP on Ceiling, Grey	05	2269			1
FRP on Rearwall, Grey	05	2040			1
FRP INTERIOR PANELS MUST HAVE AZDEL BACKERS - NOT LUAN	05	99			1
FLOORING - WHITE NOSING IS STANDARD					1
Gerflor Sirius NT #6727 Anthracite (Grey) I.L.O. Graphite	05	2823			1
Yellow Step Nosing - Per Step	05	2360			3
3/4" Marine Grade Plywood Floor	05	99			1
Raised Floor 3 Step Flat to Front ** ALLSTAR OPTION ONLY	05	2103			1
Fuel Tank Access Plate In Floor *N/A All Applications - Check Availability	05	2667			1
EXTERIOR					
Custom Paint - Requires Artwork and color Codes - * Note in Special Instructions!	05	2235			1
CHASSIS					
Heavy Duty Anti-Slip Aluminum Running Board on Driver Side (Large)	05	2623			1
Mor-Ryde RL Suspension	05	2213			1
Rear Tow Hooks	05	2002			1
Exterior Mirror Set, Remote/Heated, Ford	05	2444			1
SMI Energy Absorbing Rear Bumper	05	2812			1
Valve Stem Extender Inner Dual Rear Wheel, pair	05	2606			1
ACC CLIMATE CONTROL A/C SYSTEMS					1
ENVIRONMENTAL CONTROL					
DUAL COMPRESSOR SYSTEMS					1
R476021 85K - 23047 EVAP - 25060 2 FAN COND 13.4 C.I.D COMP (SELECT CHASSIS/ENGINE BELOW)					1
R476021 13.4 C.I.D FORD 7.3 LITRE GAS	05	2815			1
HEATERS					1
Hot Water Heater, 35K BTU 3 Speed Low Profile	05	2044			1
ELECTRICAL					1
Battery Box and Tray	05	2029			1
Laminated Wiring Schematic ***AS BUILT*** ON ELECTRICAL PANEL DOOR	05	2385			1
EXTERIOR LIGHTS					1
Surface Mount LED Entry Door Exterior Light - STD Choose Optional Below or Special builds	05	STD			1

2 LED 7" Lts-Rear Flash	REAR	Brake, Lift Door & Entry Open	05	2800		1
LED Mid-Ship Turn / Marker Lights			05	2330		1
INTERIOR LIGHTS						
Additional Interior LED Dome Lamp - Each			05	2041		2
MINIMUM OF 3 DOME LAMPS PER SIDE IS REQUIRED						
Door Activated Interior Lights			05	2097		1
AUDIO / VISUAL						
Ground Plane for 2-Way Radio, Pull Cord, Conduit Terminates B Pillar Floor			05	2132		1
DOORS / HATCH / WINDOWS						
Electric Entry Door is Standard. Add Option #2056 if Manual is Desired						
Passenger Door Electric (standard)			05	2887		1
Passenger Door 36" ROUGH OPENING (STANDARD)			05	2063		1
Exterior Passenger Entrance Door Key			05	2133		1
Extra Key for Electric Entry Door (requires opt 2133)			05	2320		2
Rear Door, (1) Window LH Hinge is Std Specify if RH		LH Hinge	05	2016		1
Additional Window for Rear Door			05	2127		1
Extra Key for Rear Door			05	2321		1
Extra Key for Wheelchair Door			05	2321		1
LUGGAGE RACK / STORAGE						
Driver Storage in Cab Overhead - AS LARGE AS POSSIBLE			05	2019		1
ADD HOLD OPEN TO OVERHEAD STORAGE DOOR			ST	0599		1
PARATRANSIT OPTIONS						
Double W.C. Doors w/ Windows, Interior Light, Leaf Spring, LED Exterior Lighting			05	2015		1
IS THE LIFT IN THE FRONT OR REAR OF THE UNIT?		REAR				1
USE A.L. HANSEN TYPE 23 SPRING ON LIFT DOORS I.L.O. GAS SHOCKS			05	99		2
BRAUN LIFTS						
Braun Century NCL 1000 3454HB-2 1000# (34"x54") *N/A FRONT LIFT 138/139"WB			05	2819		1
LIFT FAST IDLE WITH 403 INTERLOCK						
Intermotive Gateway 508-F Ford E Fast Idle with Lift Interlock			05	99		1
Q Straint W.C. Securement Kits, Accessories						
Q-8301-L Max Retrctr Tie Down, Q8-6326-A1 Comb Lap/Shldr, L Trk			05	2536		4
Q5-7580-4 18" Blue Webbing Loops			05	2846		16
Q-STRAINT BELT CUTTER INSTALLED IN DRIVER'S AREA			05	99		1
Q-Straint Belt Cutter (ship loose)			05	2179		1
Miscellaneous Accessories						
L Track for Wheelchair Tiedown (per foot) Floor			05	2391		4
Priority Seating Signs Installed on each of the 2 Front Row Seats			05	2104		2
Wheelchair Decal (International Symbol of Accessibility) Each			05	2105		2
SAFETY OPTIONS						
5 Lb Fire Extinguisher			05	2089		1
Special First Aid Kit from American Safety Spec 182 (Metal Box)			05	99		1
Body Fluid Kit			05	2150		1
Emergency Triangle Kit			05	2091		1
Back-Up Alarm SAE Type C 97 db(A)			05	2092		1
Interior Flat Mirror, 6" x 16"			05	2118		1
Wide Angle Lens 11"x14", Fresnel			05	2124		1
Red Light Over Emergency Exit Ea: ON: ALL EMERGENCY EGRESS			05	2155		3
GRAB RAIL / STANCHION / PANELS						
Ceiling Grab Rail (each) If 1 Specify Side:			05	2050		2
1 1/4" Dual Entry Grab Rails Parallel to Entrance Steps (both sides)			05	2130		1
Stanchion and Modesty Panel Behind Driver			05	2051		1
SEATING - DRIVER						
SHIELD FC Recliner(GM&Ford), RH Arm, 4 Position Lumbar, Mesh Pocket			05	2064		1
FREEDMAN SHIELD & LO CAM DRIVER SEAT FABRICS						
Driver Seat Cover - Level 3 Regions or any Level 3 Combo			05	2042		1
SEATING - PASSENGER						
STD RIGID SEATS						
Mid High Double Seat			05	2067		4
FOLDAWAY SEATS						
Foldaway Seat, Double AM Benchback			05	2084		2
PASSENGER SEAT FABRICS						
Seat Cover - Level 3 Regions or any Level 3 Combination (Sherpa/Shire N/A)			05	2073		12
SEAT OPTIONS						
Anti-Vandal Grab Handle, Black Ea on:		All Fixed Seats	05	2311		8
Black US Armrest - Each - on:		Aisle Side	05	2077		6
TDSS-L Track on Foldaways Ea. Note Location in Special Instructions & Floor Plan			05	2680		2
SEAT BELTS						
Seat Belt, Non-Retractable ****STANDARD ITEM - ENTER QUANTITY			05	2086		12
Seat Belt Extension, 24" FOR USR SEAT BELTS			05	2811		2